



## INSTRUCTIONS FOR **IRON INFUSION** REFERRAL FORM

SA Infusion Services is excited to announce that we have worked closely with the IT team at **Xestro** to create a **fillable referral form which can easily be completed within Xestro itself!**

1. Within Xestro, open the Patient's file and click "Form" in the bottom right panel (shown below)

The screenshot displays the Xestro interface for a patient's file. The main area shows a list of items with actions like 'Delete | Edit' and 'Create Letter | Delete | Edit | View Changes'. On the right, a sidebar contains various data points and a menu. The menu items are: Quick Letter, Document, Label, Form (highlighted with a red box), Questionnaire, and Library. A red arrow points from the 'Form' button to the 'Document' button. Below the sidebar, there is a user profile section with a placeholder for a profile picture, the text 'Xestro Support', and navigation buttons for Contacts, Admin, myXestro, and Help. The Xestro logo is also visible in the bottom right corner.

Pregnancy Month Due	May
10 Apr 26	
EDD by dates	2027-05-03
10 Apr 26	
Expected Date of Delivery (EDD)	-12+-4/40 (3 May 27)
10 Apr 26	
Pregnancy Birth Date	2026-04-10
10 Apr 26	
Final Gestation	25+3
10 Apr 26	

**Social & Family History**  
No Social & Family History

**test SA**  
No test SA

are required before full functionality can be enabled

more...

Xestro Support

Contacts Admin myXestro Help

Xestro

- A new window will now open on your screen. In this window, please type “SA Infusion Services Referral Form” into the search bar at the top, and you should see a preview of our referral form. The next step is to click “Fill out now” in the bottom set of buttons (shown below)

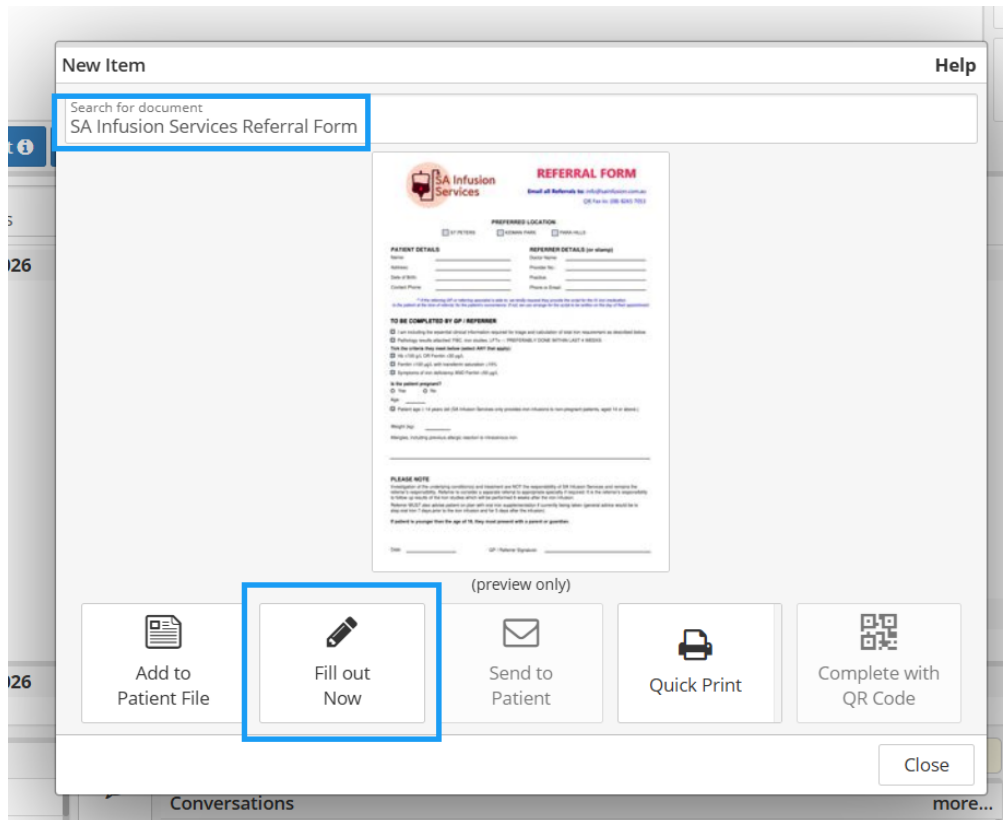

- A new window with the heading “Creating Form” will now appear. You will be able to now complete any required fields, but most will be **auto-completed by Xestro** from the patient’s record. **You can then use the Drawing Tool (pencil icon) to sign the referral form.**

